



EDUCATION SECTOR

DEGREE COLLEGE

REQUIREMENTS ARE BASED ON STANDARDS GIVEN IN THE

NATIONAL REFERENCE MANUAL ON PLANNING & INFRASTRUCTURE STANDARDS



EDUCATIONAL FACILITIES

STAFF	No.	TITLE	AREA
• Principal	01	1. Class Rooms	(18) 10,134 SFT
• Teachers	22	2. Laboratories	
• No. of class Rooms	18	• Physics Lab	856 SFT
• No Of Students/Section	35	• Chemistry Lab	856 SFT
• Total Nos. Of Students	630	• Biology Lab	1141 SFT
		• Computer Lab	1141 SFT
		3. Principal's Room	371 SFT
		4. Staff Room	346 SFT
		5. D.P.E Office	168 SFT
		6. Sports Store	225 SFT
		7. Store	225 SFT
		8. Admin Section	346 SFT
		9. Multipurpose Hall	1500 SFT
		10. Dispensary	128 SFT
		11. Art/Science Room	856 SFT
		12. Library / Reading / Librarian	1918 SFT
		13. Sports /Photocopy Room	1034 SFT
		14. Lecture Theater	(02) 1126 SFT
		15. Bathrooms	
		• Staff Toilets	(05) 215 SFT
		• Students Toilet	(04) 812 SFT
		Total	23,398 SFT
		Circulation Space + Wall	18,383 SFT
		TOTAL COVERED AREA	41,781 SFT



EDUCATIONAL FACILITIES



General note :
Design may be adjusted due to following parameters

1. Seismic parameters
2. User requirement
3. Site parameters

TYPICAL DESIGN - DEGREE COLLEGE



EDUCATIONAL FACILITIES

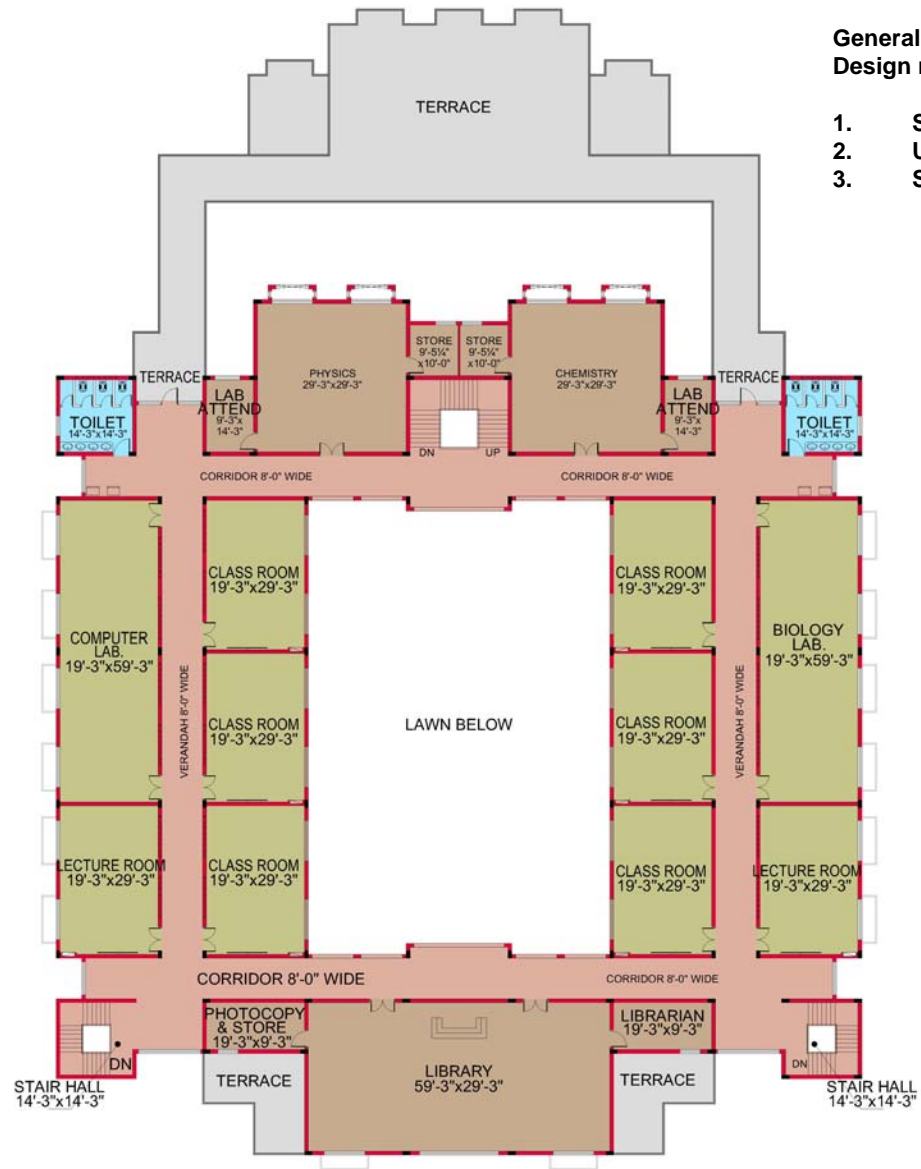

General note :
Design may be adjusted due to following parameters

1. Seismic parameters
2. User requirement
3. Site parameters

FIRST FLOOR PLAN
COVERED AREA : 19,191 SFT

TYPICAL DESIGN - DEGREE COLLEGE



EDUCATIONAL FACILITIES



TYPICAL DESIGN - DEGREE COLLEGE